

The below illustration identifies the terminology of the items used to assemble the ACCU-SLIDE ECONO . Items denoted with a  are unique to the RV Specifications of the Slide-out Opening, Room Depth, Room Length and Room Height. Identifying the correct part number for these, requires the mechanism part number located on the main bracket.

854202
LABEL, ACCU SLIDE CABLE
ADJUSTMENT INSTRUCTIONS

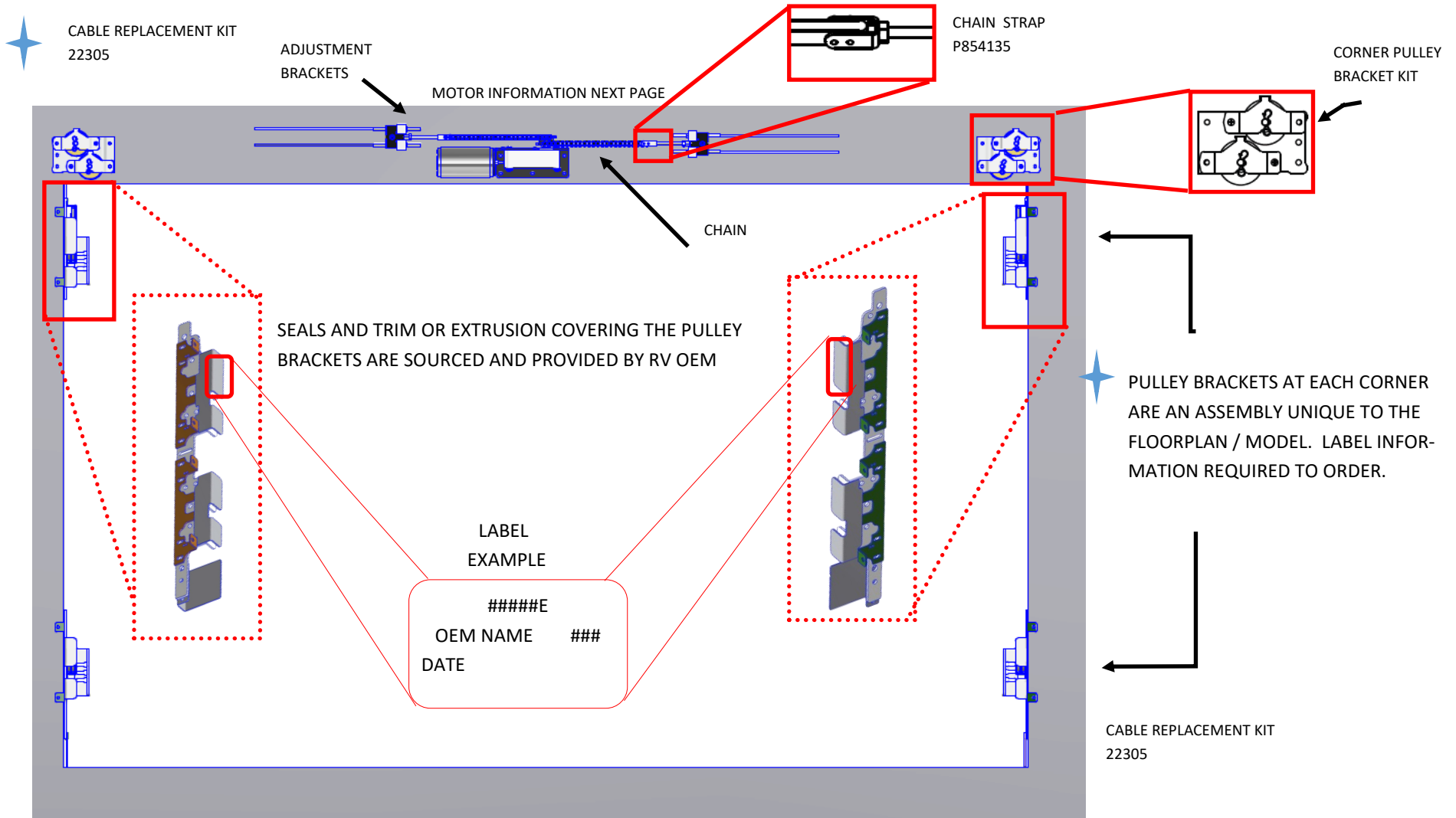

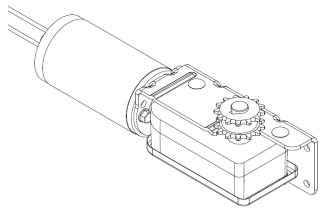

21900000
MOTOR & GEARBOX 64ZY
SPROCKET UP

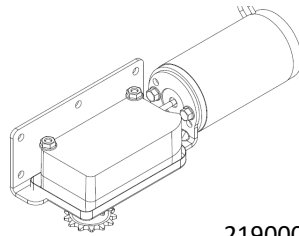

21900001
MOTOR & GEARBOX 64ZY
SPROCKET DOWN

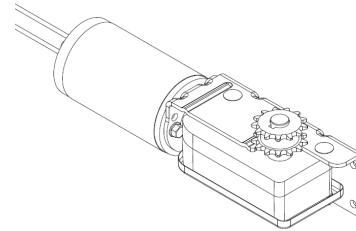

21900002
MOTOR & GEARBOX 68ZY
SPROCKET UP HIGH TORQUE

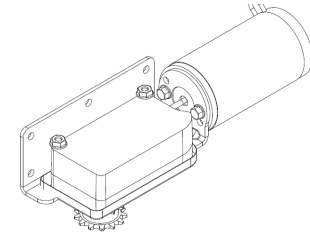

21900003
MOTOR & GEARBOX 68ZY
SPROCKET DOWN HIGH TORQUE

WIPE SEALS

WIPE SEALS ARE SOURCED BY THE RV OEM BY AN ALTERNATIVE SUPPLIER.



P854775
FELXIBLE OVERRIDE SHAFT WITH #2 SQUARE BIT



R854323
CHAIN
UNIVERSAL FOR ALL ACCU SLIDE SYSTEMS



P854135
STRAP, CHAIN CONNECTOR

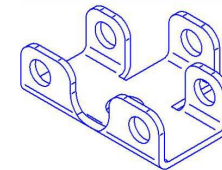

P854014
BRACKET, CHAIN / CABLE
CONNECTOR



22302R
CORNER PULLEY RIGHT HAND

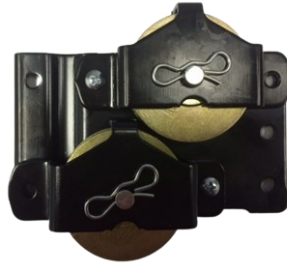

22302L
CORNER PULLEY LEFT HAND



25043
DOUBLE BACK CORNER



25042
DOUBLE BACK CORNER



R854057 - 32" Z CABLE SEPARATOR



22504
CABLE CHAIN ADJUSTMENT KIT



22509
DOUBLE BACK CABLE CHAIN ADJUSTMENT KIT

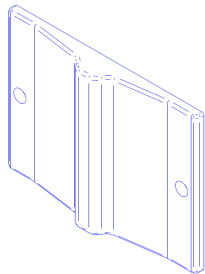

10800036
TRACKING GUIDE

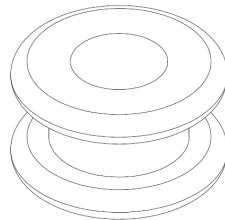

854195
RUBBER GROMMET .281 ID X .6245 OD



854266
ANTI-VIBRATION FOAM

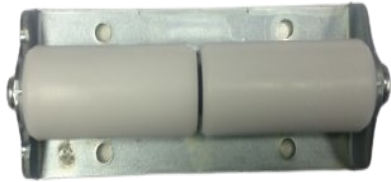

854275
FLOOR ROLLER

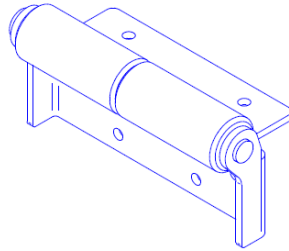

854303
AFTERMARKET ROLLER USED TO ASSIST 3/4" WEAR BAR

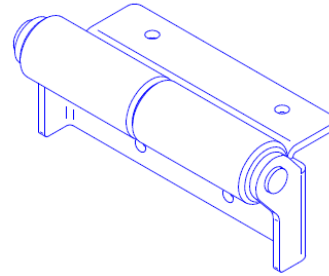

854304
AFTERMARKET ROLLER USED TO ASSIST 1/2" WEAR BAR



SLIDE OUT TRACKING ROLLER
(Discontinued) Replace with Tracking Guide 10800036



P854282R
COMPRESSION ROLLER RIGHT HAND FOR FLUSH FLOOR



P854282L
COMPRESSION ROLLER RIGHT HAND FOR FLUSH FLOOR



COMPRESSION ROLLER BLOCK
 F854728 1.5"
 F854730 1.88"
 F854731 2.0"
 F854732 1.25"
 F854733 3.00"
 F854734 4.0"
 F854735 2.5"

FOR FLUSH FLOOR



COUPLING NUTS
 854157 1/4" X 1 3/4"
 854164 1/4" X 7/8"

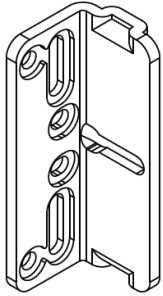

P854757
OUTSIDE STANDOFF
BRACKET G4 ECONO

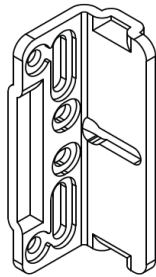

P854750
OUTSIDE STANDOFF
BRACKET G4 ECONO

NUT, COUPLING HEX 1/4-20 X 0.875
EYE BOLT, 1/4-20 X 5 X 1/2 EYE
EXPANDABLE SLEEVING, BRAIDED POLY MESH TUBING
CRIMP SLEEVE
CABLE ASSEMBLY, 5/32 7 X 19SS X 200 ONE BALL
GROMMET, RUBBER
INSTRUCTIONS, MODEL 22305 CABLE REPLACEMENT KIT
LABEL, 1.55 X .875
PLASTIC BAG 8 X 10
FOAM, ANTI-VIBRATION INSERT .85 X .85

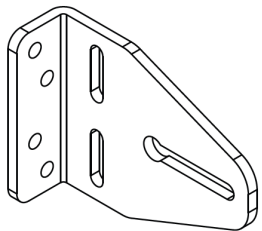
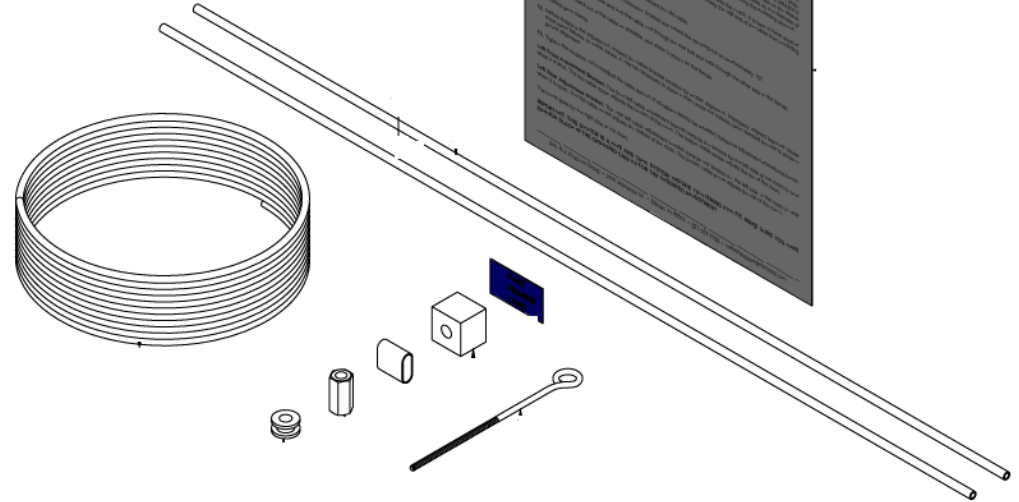

P854129
INSIDE STANDOFF BRACKET

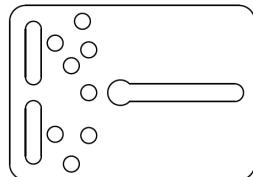

P854130
INSIDE STANDOFF BRACKET

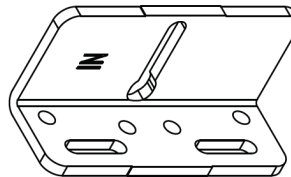

P854196
INSIDE STANDOFF BRACKET

22305

CABLE REPLACEMENT KIT
UNIVERSAL FOR ALL ACCU-SLIDES