

The below illustration identifies the terminology of the items used to assemble the ACCU-SLIDE HYBRID. Items denoted with a  are unique to the RV Specifications of the Slide-out Opening, Room Depth, Room Length and Room Height. Identifying the correct part number for these, requires the mechanism part number located on the label inside the jamb.

854202
LABEL, ACCU SLIDE CABLE
ADJUSTMENT INSTRUCTIONS

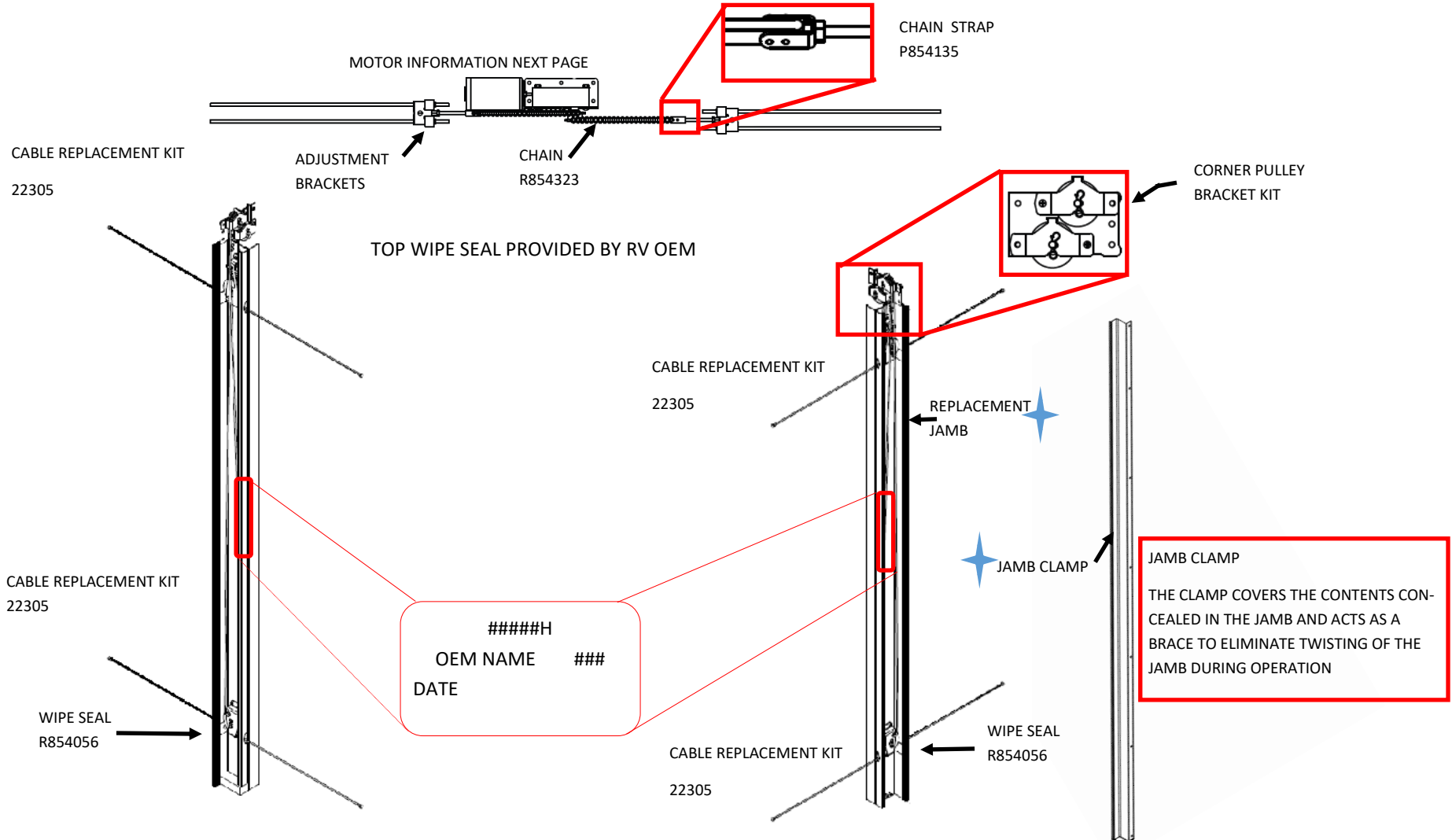

NOTE: RIVETED PARTS ARE NOT CONSIDERED SERVICABLE. THE COMPLETE RIGHT HAND OR

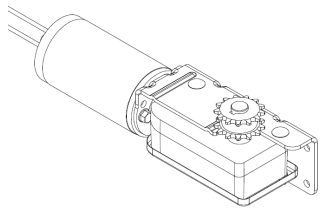

2190000
MOTOR & GEARBOX 64ZY

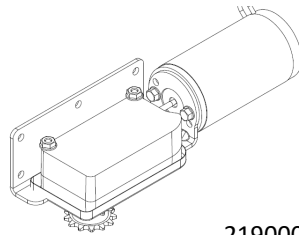

2190001
MOTOR & GEARBOX 64ZY
SPROCKET
DOWN

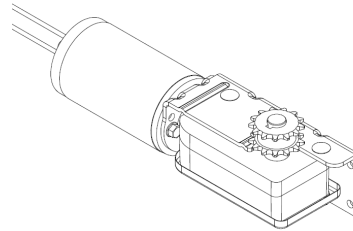

2190002
MOTOR & GEARBOX 68ZY
SPROCKET UP HIGH TORQUE

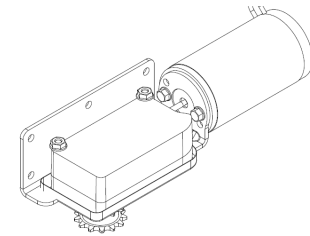

2190003
MOTOR & GEARBOX 68ZY
SPROCKET DOWN HIGH TORQUE

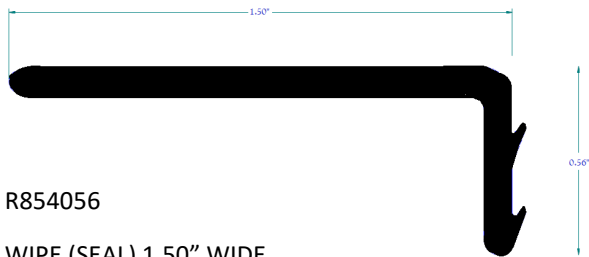

R854056
WIPE (SEAL) 1.50" WIDE
HYBRID ACCU SLIDE



P854775
FELXIBLE OVERRIDE SHAFT WITH #2 SQUARE BIT



R854323
CHAIN
UNIVERSAL FOR ALL ACCU SLIDE SYSTEMS

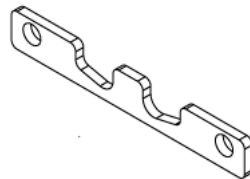

P854067
SHIM, CORNER PULLEY BRACKET



P854135
STRAP, CHAIN CONNECTOR

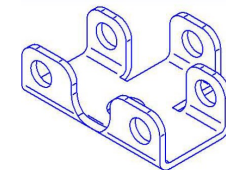

P854014
BRACKET, CHAIN / CABLE CONNECTOR



CABLE ADJUSTMENT INSTRUCTIONS (Colors indicate adjuster brackets) #54002

IMPORTANT: THIS SYSTEM IS A GIVE AND TAKE SYSTEM. BEFORE TIGHTENING FOR FIT, MAKE SURE YOU HAVE ENOUGH SLACK IN THE OPPOSING CABLES FOR THE REQUIRED ADJUSTMENT.

| | |
|--|---|
| LEFT FRONT controls tension for the left side seal when room is out. Top cable screw adjusts the room bottom. (Opposing cable: Left rear top) Bottom cable screw adjusts the room top. (Opposing cable: Left rear bottom) | RIGHT FRONT controls tension for the right side seal when it is in. Top cable screw adjusts the room bottom. (Opposing cable: Right rear top) Bottom cable screw adjusts the room top. (Opposing cable: Right rear bottom) |
| LEFT REAR controls tension for the left side seal when room is in. Top cable screw adjusts the room bottom. (Opposing cable: Left front top) Bottom cable screw adjusts the room top. (Opposing cable: Left front bottom) | RIGHT REAR controls tension for the right side seal when it is out. Top cable screw adjusts the room bottom. (Opposing cable: Right front top) Bottom cable screw adjusts the room top. (Opposing cable: Right front bottom) |

BAL ACCU-SLIDE BAL is a registered trademark of Norco Industries, Inc. © Norco Industries, Inc. 2016

ACCU-SLIDE HYBRID PARTS IDENTIFICATION



22302R
CORNER PULLEY RIGHT HAND



22302L
CORNER PULLEY LEFT HAND



25043
DOUBLE BACK CORNER



25042
DOUBLE BACK CORNER



R854057 - 32" Z CABLE SEPARATOR



22504
CABLE CHAIN ADJUSTMENT KIT



22509
DOUBLE BACK CABLE CHAIN ADJUSTMENT KIT

R854071 - 42" Z CABLE SEPARATOR

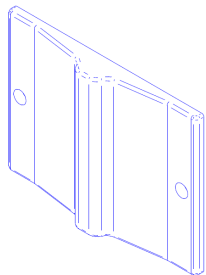

10800036
TRACKING GUIDE

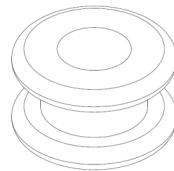

854195
RUBBER GROMMET .281 ID
X .6245 OD



854266
ANTI-VIBRATION FOAM

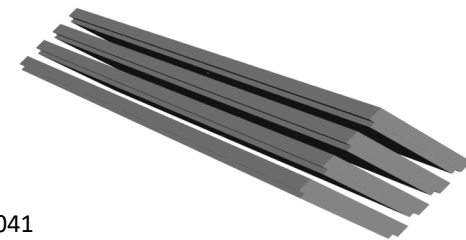

25041
CABLE PATCH KIT 4" (4 PER KIT)

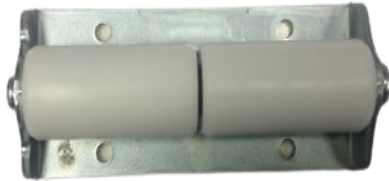

854275
FLOOR ROLLER

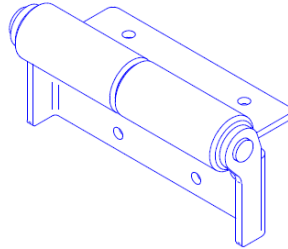

854303
AFTERMARKET ROLLER USED TO
ASSIST 3/4" WEAR BAR

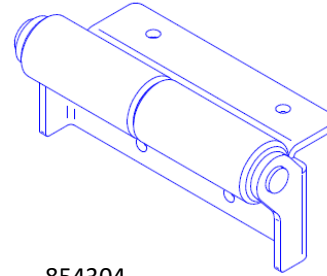

854304
AFTERMARKET ROLLER USED TO
ASSIST 1/2" WEAR BAR



854599
SLIDE OUT TRACKING ROLLER



P854282R
COMPRESSION ROLLER RIGHT
HAND FOR FLUSH FLOOR



P854282L
COMPRESSION ROLLER RIGHT
HAND FOR FLUSH FLOOR



COMPRESSION ROLLER BLOCK
 F854728 1.5"
 F854730 1.88"
 F854731 2.0"
 F854732 1.25"
 F854733 3.00"
 F854734 4.0"
 F854735 2.5"

FOR FLUSH FLOOR



COUPLING NUTS
 854157 1/4" X 1 3/4"
 854164 1/4" X 7/8"

CABLE ADJUSTMENT INSTRUCTIONS (Colors indicate adjuster brackets) #54002

IMPORTANT: THIS SYSTEM IS A GIVE AND TAKE SYSTEM. BEFORE TIGHTENING FOR FIT, MAKE SURE YOU HAVE ENOUGH SLACK IN THE OPPOSING CABLES FOR THE REQUIRED ADJUSTMENT.

LEFT FRONT controls tension for the left side seal when room is out. (Opposing cable: Left rear top)
RIGHT FRONT controls tension for the right side seal when it is in. (Opposing cable: Right rear top)

LEFT REAR controls tension for the left side seal when room is in. (Opposing cable: Left front top)
RIGHT REAR controls tension for the right side seal when it is out. (Opposing cable: Right front top)

GREEN Top cable screw adjusts the room bottom. (Opposing cable: Right rear top)
RED Bottom cable screw adjusts the room top. (Opposing cable: Right rear bottom)

BLUE Top cable screw adjusts the room bottom. (Opposing cable: Left front top)
PURPLE Bottom cable screw adjusts the room top. (Opposing cable: Left front bottom)

BAL ACCU-SLIDE BAL is a registered trademark of Norco Industries, Inc. © Patent #264171
 2013-11-01
 Patent Pending

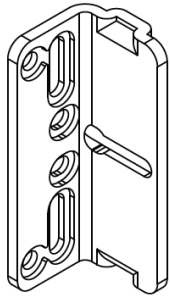

P854584
OUTSIDE STANDOFF
BRACKET HYBRID

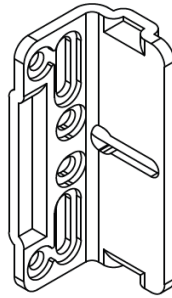

P854749
OUTSIDE STANDOFF BRACKET
HYBRID

| |
|---|
| NUT, COUPLING HEX 1/4-20 X 0.875 |
| EYE BOLT, 1/4-20 X 5 X 1/2 EYE |
| EXPANDABLE SLEEVING, BRAIDED POLY MESH TUBING |
| CRIMP SLEEVE |
| CABLE ASSEMBLY, 5/32 7 X 19SS X 200 ONE BALL |
| GROMMET, RUBBER |
| INSTRUCTIONS, MODEL 22305 CABLE REPLACEMENT KIT |
| LABEL, 1.55 X .875 |
| PLASTIC BAG 8 X 10 |
| FOAM, ANTI-VIBRATION INSERT .85 X .85 |

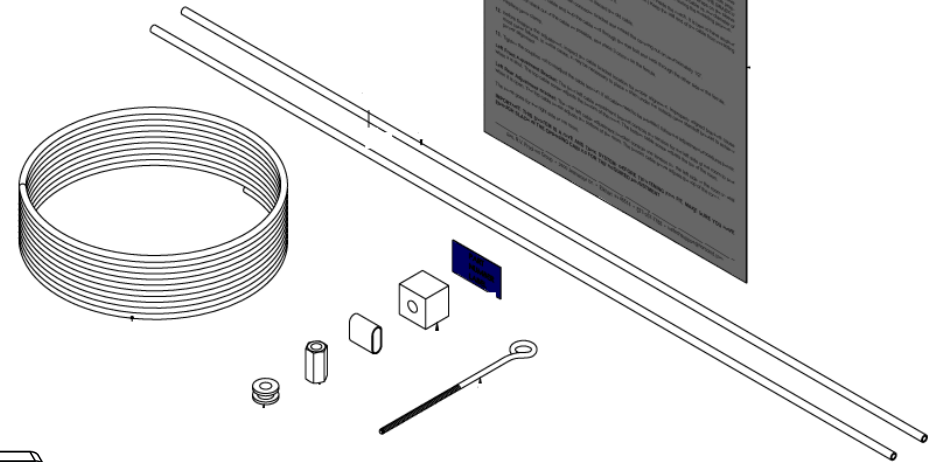

22305
CABLE REPLACEMENT KIT
UNIVERSAL FOR ALL ACCU-SLIDES

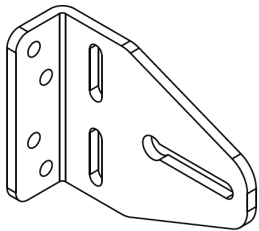

P854129
INSIDE STANDOFF
BRACKET

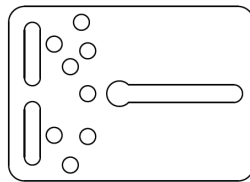

P854130
INSIDE STANDOFF
BRACKET

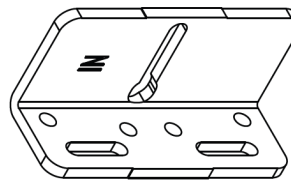

P854196
INSIDE STANDOFF BRACKET